

# HSF

## NOTES:

Rated Current: 3.0~9.0 AMP.  
 Contact Resistance: 20mΩ Max.  
 Withstand Voltage: 500V AC  
 Insulation Resistance: 1000MΩ Min.  
 Operation Temperature: -40°C to +105°C  
 Applicable Wire Range:  
 - Solid Wire: AWG #20~#18  
 - Strand Wire: AWG #20~#18

Contact Material: Phosphor Bronze (C5191)  
 Contact Plating: Sn over Ni  
 Main Body Material: LCP

Recommended P.C.B Layout (Top Side)  
 (PCB BOARD TOLERANCE ±0.05)

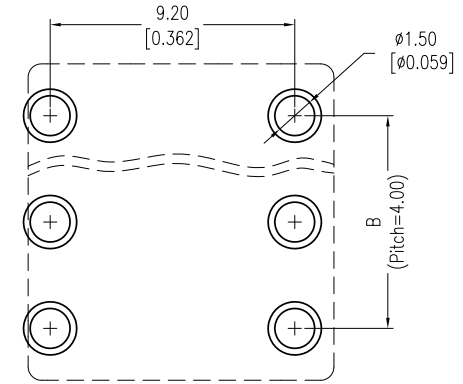
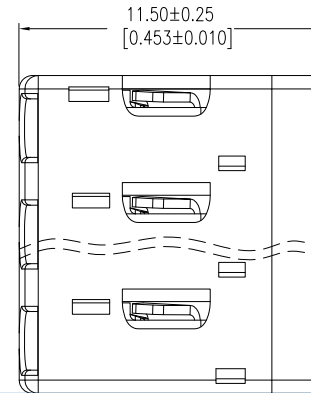

### Ordering Information:

**5823 - T- XX- 1**  
 1 2 3

#### 1. Connector Series

#### 2. (T) Contact Plating

- T = 2. Tin plated (Recommended Finish)

#### 3. (XX) Number of circuits

- Available in 1, 2, and 3 circuits

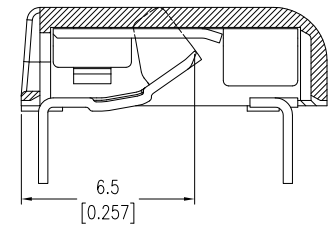
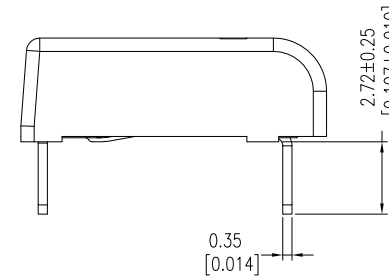
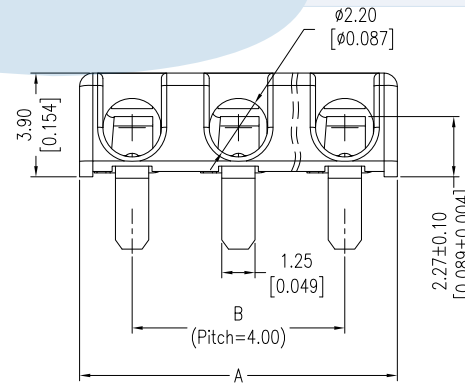

3	11.95	8.00
2	7.90	4.00
1	3.95	/
PIN	A	B

REV	DATE	MODIFICATION DESCRIPTION	CHANGE	OPERATION	DRAW	DATE	SCALE	Fit	PART NO.
				X.X ±0.40	Allen	2015/09/22	UNIT	mm	5823 Series
				X.XX ±0.25	CHECK	DATE	SIZE	A4	TITLE:
				X.XXX ±0.15			SHEET	1/1	4.0Pitch LED CONN. H=4.00 90° DIP
				Angle ± 3'	APPROVE	DATE	PROJ.	Customer NO.	
				DIM TOL					

