

# SINGLE ROW VERTICAL PIN HEADER



## 3986 SERIES. 3.96 mm (0.156") pitch.

### General Features

- Available in 2 through 20 circuits
- Mates with PCB sockets 3.96mm pitch 3970, 3971, 3972, 3915, 3916; Wire housing 3940, 3930, 2631 and 3950 series
- 1.14 mm. round pin tin plated
- With standoff to minimise flux retention
- Easy breakaway desired circuit size

### Materials

- Insulator: Glass filled Polyester UL 94 V-0
- Contact: brass
- Operating temperature: -40°C to +85°C
- RoHS compliant

### Dimensional Information

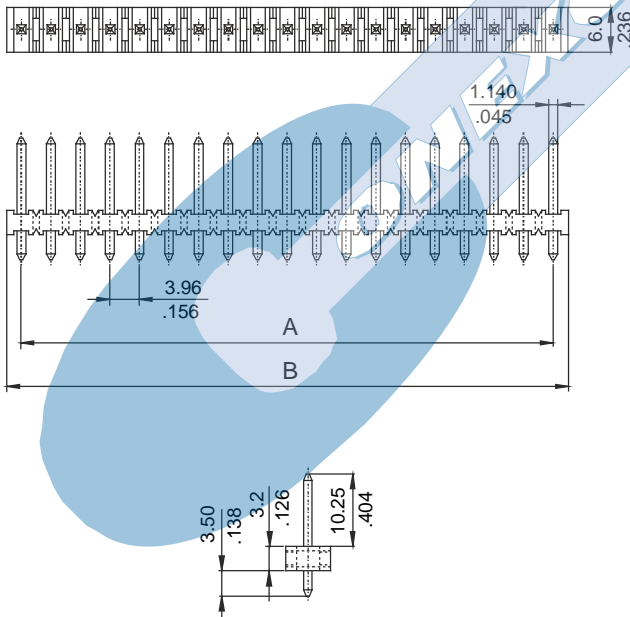

### RECOMMENDED HOLE PATTERN

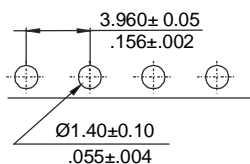

### Electrical Features

- Voltage rating: < 250V
- Current rating: < 5 A
- Contact resistance: < 20 mΩ
- Dielectric withstanding voltage: 1500 V AC/minute
- Insulation resistance: >1000 MΩ

### Mechanical Features

- Pin retention force to insulator: > 0,50 Kgf
- Durability: 25 cycles

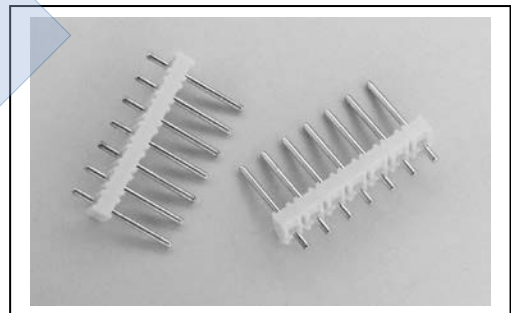

### Ordering Information:

**3986 - T- XX- 1**  
1 2 3

#### 1. Connector Series

#### 2. (T) Contact Plating

- T = 2. Tin plated  
Recommended Finish

#### 3. (XX) Number of circuits

- Available in 2 through 20 circuits

Dimensions: (In mm.)

A = 3.96 x (XX\*-1)

B = 3.96 x (XX\*)

\* XX (Number of circuits)