

FLAT CABLE IDC EDGE CARD



5449 SERIES. 2.54 mm. (0.100") pitch.

General Features

- Available in 10, 14, 16, 20, 26, 34, 40, 44, 50, 56, 60, 62 and 64 circuits
- Accept edge card 1.57 mm thickness
- Wires range : 28 AWG O.D max. 0.85 mm
- Use flat cable 1.27 mm pitch 9127 series
- With strain relief

Materials

- Insulator: PBT glass reinforced UL 94V-0
- Contact: Phosphor bronze
- Operating temperature. -40°C to +105°C
- RoHS compliant

Dimension Information

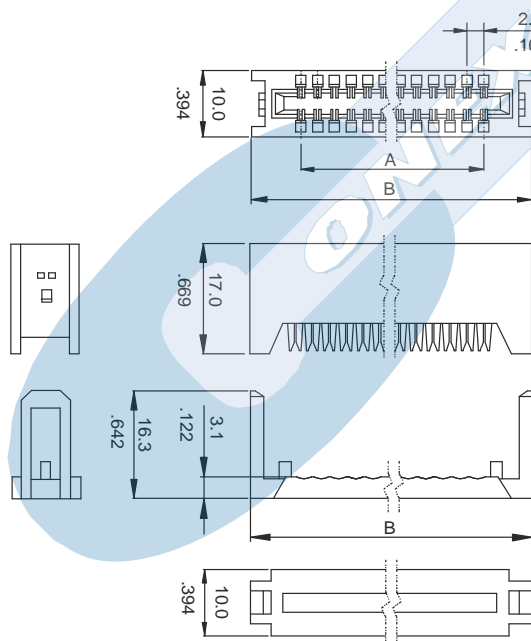

5449 - Txx1 (Polarizator position)

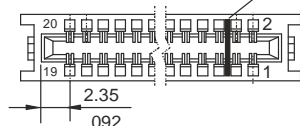

Strain Relief

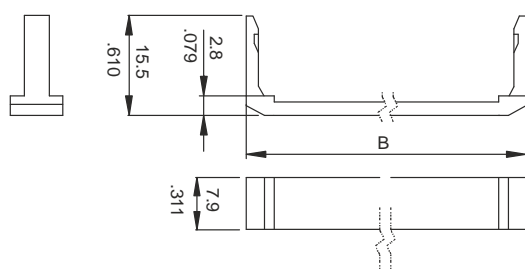

Electrical Features

- Voltage rating: < 250V
- Current rating: < 1 A
- Contact resistance: < 30 mΩ
- Dielectric withstanding Voltage: 500 V AC/minute
-

Mechanical features

- Durability: 50 cycles

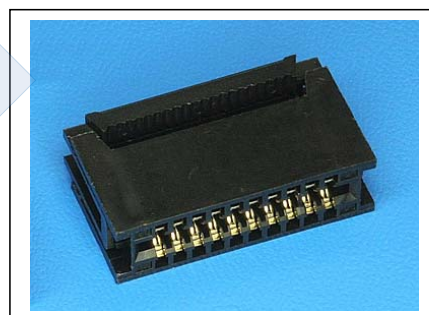

Ordering Information:

5449 - T - XX - 0

1 2 3 4

1. Connector Series

2. (T) Contact Plating

- T = 2. Tin plated
- T = 3. Gold flash over nickel
Recommended Finish
- T = 5. 15μ" gold over nickel
- T = 6. 30μ" gold over nickel

3. (XX) Number of circuits

- Available in 10 through 64 circuits
Available Narrow version (7.62 mm.)
In 28 circuits (5448-T282)

RECOMMENDED PCB DIMENSIONS

