

- MATERIAL: NYLON 66 (UL)
- FLAME CLASS :94V-2
- COLOR:NATURAL
- UNIT:mm

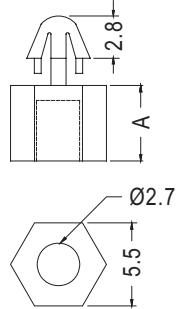

P.C.B Ø3.0  
THICKNESS 1.6



PART NO	A	PACKAGE
MAE-5	5.0	2000
MAE-6	6.0	
MAE-7	7.0	
MAE-8	8.0	
MAE-9	9.0	
MAE-10	10.0	
MAE-11	11.0	1000
MAE-12	12.0	
MAE-13	13.0	

PART NO	A	PACKAGE
MAE-14	14.0	1000
MAE-15	15.0	
MAE-16	16.0	
MAE-17	17.0	
MAE-18	18.0	
MAE-19	19.0	
MAE-20	20.0	
MAE-22	22.0	
★MAE-26	26.0	

P.C.B Ø3.0  
THICKNESS 1.6

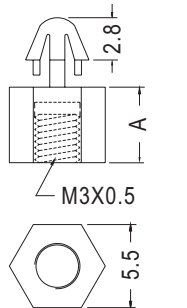

PART NO	A	PACKAGE
MAE-5T	5.0	2000
MAE-6T	6.0	
MAE-7T	7.0	
MAE-8T	8.0	
MAE-9T	9.0	
MAE-10T	10.0	
MAE-11T	11.0	1000
MAE-12T	12.0	
MAE-13T	13.0	

PART NO	A	PACKAGE
MAE-14T	14.0	
MAE-15T	15.0	
MAE-16T	16.0	
MAE-17T	17.0	
MAE-18T	18.0	
MAE-19T	19.0	
MAE-20T	20.0	
MAE-22T	22.0	
★MAE-26T	26.0	

- MAE-XT M3X0.5P

- MATERIAL: NYLON 66 (UL)
- FLAME CLASS :94V-2
- COLOR:NATURAL
- UNIT:mm



P.C.B Ø4.0  
THICKNESS 1.6

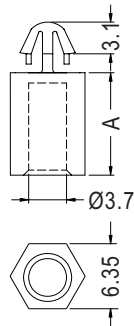

PART NO	A	PACKAGE
MAE4-5	5.0	2000
MAE4-6	6.0	
MAE4-7	7.0	
MAE4-8	8.0	
MAE4-9	9.0	
MAE4-10	10.0	
MAE4-11	11.0	
MAE4-12.7	12.7	
MAE4-15.9	15.9	
MAE4-20	20.0	

P.C.B Ø4.0  
THICKNESS 1.6

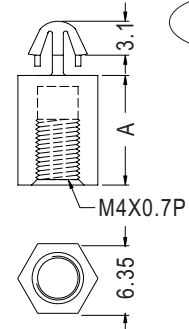

- MAE4-XT M4X0.7P

PART NO	A	PACKAGE
MAE4-5T	5.0	2000
MAE4-6T	6.0	
MAE4-7T	7.0	
MAE4-8T	8.0	
MAE4-9T	9.0	
MAE4-10T	10.0	
MAE4-11T	11.0	
MAE4-12.7T	12.7	
MAE4-15.9T	15.9	
MAE4-20T	20.0	