

SPACER SUPPORT

PLASTECH

- MATERIAL: NYLON 66 (UL)
- FLAME CLASS :94V-2
- COLOR:NATURAL
- UNIT:mm

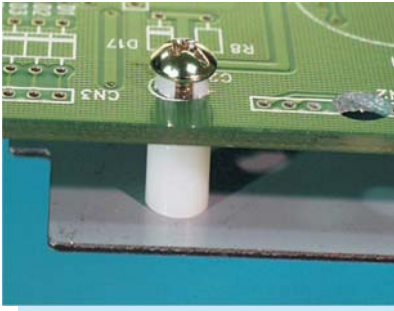

P.C.B Ø4.8
THICKNESS 1.2~1.7

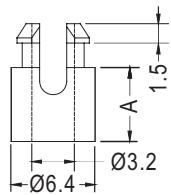

FOR #4(M3) SCREW

PART NO	A	PACKAGE
SS-3	3.2	1000
SS-3.5	3.5	
SS-4	4.0	
SS-4.5	4.5	
SS-5	4.8	
SS-6	6.4	
SS-8	7.9	

PART NO	A	PACKAGE	
SS-10	9.5	1000	
SS-11	11.1		
SS-12A	12.0		
SS-12	12.7		
SS-14	14.2		
SS-15	15.0		
SS-16	15.9		
SS-19	19.1		
SS-22	22.2		500
SS-25	25.4		

SPACER SUPPORT

PLASTECH

- MATERIAL: NYLON 66 (UL)
- FLAME CLASS :94V-2
- COLOR:NATURAL
- UNIT:mm

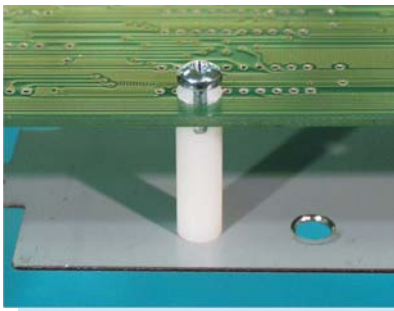

P.C.B Ø5.9
THICKNESS 1.2~1.7

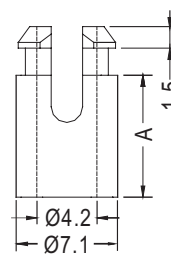

FOR #6(M3.5) SCREW
OR #8(M4) SCREW

PART NO	A	PACKAGE	
SS4-3	3.0	1000	
SS4-4	4.0		
SS4-4.6	4.6		
SS4-5	5.0		
SS4-6	6.4		
SS4-8	7.9		
SS4-9	9.5		
SS4-11	11.1		
SS4-12	12.7		
SS4-16	15.9		
SS4-17	17.0		
SS4-19	19.1		
SS4-22	22.2		500
SS4-25	25.4		
SS4-30	30.0		

SPACER SUPPORT

PLASTECH

- MATERIAL: NYLON 66 (UL)
- FLAME CLASS :94V-2
- COLOR:NATURAL
- UNIT:mm

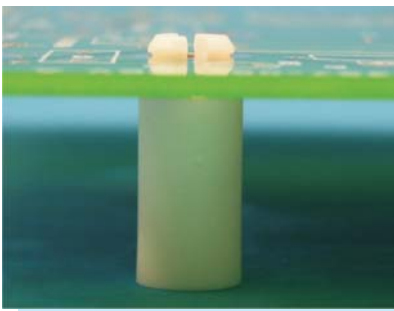

P.C.B Ø5.9
THICKNESS 1.8

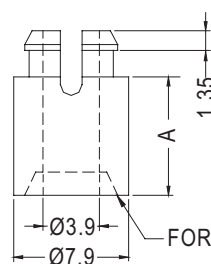

FOR M3.5 SCREW

PART NO	A	PACKAGE
SS3.5-6.3	6.3	1000
SS3.5-9.5	9.5	
SS3.5-12.7	12.7	
SS3.5-15	15.9	