

CABLE TIE MOUNT

PLASTECH

- MATERIAL: NYLON 66 (UL)
- FLAME CLASS :94V-2
- COLOR:NATURAL
- UNIT:mm

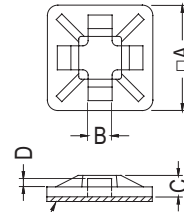
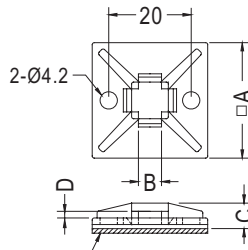

3M DOUBLE ADHESIVE TAPE
(THICKNESS 1.1mm)
ONLY FOR:CM-28S

3M DOUBLE ADHESIVE TAPE
(THICKNESS 1.1mm)

PART NO	A	B	C	D	PACKAGE
CM-13	13.0	3.2	3.2	1.3	1000
CM-16	16.0	3.8	4.0	1.5	
CM-19	19.1	4.0	4.0	1.6	
CM-20	20.0	4.8	4.2	1.6	500
CM-28S	28.0	5.6	5.2	1.6	250

CABLE TIE MOUNT

PLASTECH

- MATERIAL: NYLON 66 (UL)
- FLAME CLASS :94V-2
- COLOR:NATURAL
- UNIT:mm

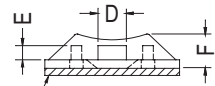
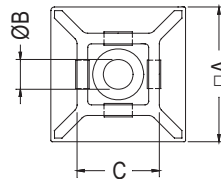
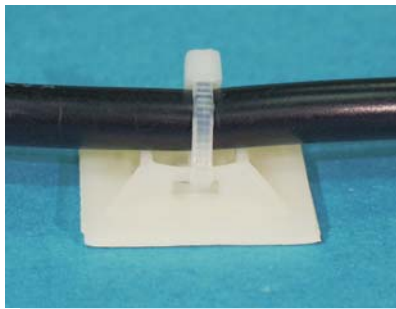

3M DOUBLE ADHESIVE TAPE
(THICKNESS 1.1mm)

PART NO	A	B	C	D	E	F	PACKAGE
CM-19S	19.0	4.0	11.6	4.0	1.9	5.0	500
CM-28	27.8	5.6	13.2	5.6	2.0	5.5	250

CABLE TIE MOUNT

PLASTECH

- MATERIAL: NYLON 66 (UL)
- FLAME CLASS :94V-2
- COLOR:NATURAL
- UNIT:mm

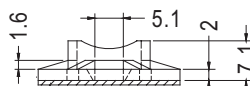
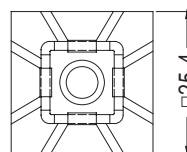

3M DOUBLE ADHESIVE TAPE
(THICKNESS 0.8mm)

PART NO	PACKAGE
CM-25	500