

# SNAP BUSHING

PLASTECH

- MATERIAL: NYLON 66(UL)
- FLAME CLASS :94V-2/94V-0
- COLOR: BLACK
- UNIT: mm

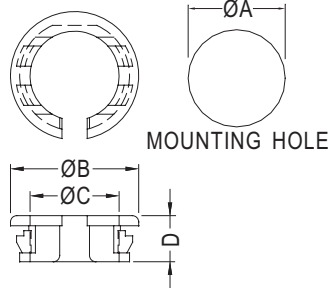

THICKNESS 0.8~1.6

PART NO	A	B	C	D	PACKAGE
NB-09	9.5	12.4	7.6	6.0	1000
NB-12	12.7	16.8	10.8	7.3	
NB-16	15.9	20.3	14.1	7.3	500
NB-19	19.0	22.5	16.5	7.3	
NB-22	22.0	26.0	20.0	7.3	
NB-25	25.4	28.6	22.0	7.9	

# SNAP BUSHING

PLASTECH

- MATERIAL: NYLON 66(UL)
- FLAME CLASS :94V-2/94V-0
- COLOR: BLACK
- UNIT: mm

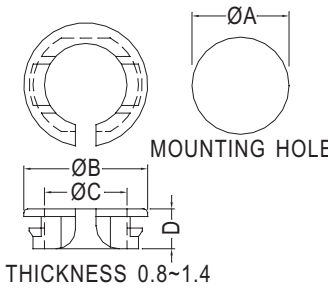
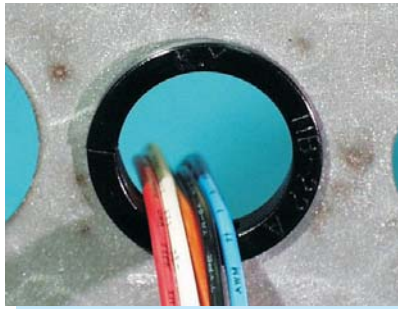

THICKNESS 0.8~1.4

PART NO	A	B	C	D	PACKAGE
NB-07A	7.0	10.4	6.0	4.8	1000
NB-12A	12.7	16.2	10.8	5.2	
NB-16A	16.0	19.3	13.0	5.2	500
NB-19A	19.0	22.9	15.6	5.5	
NB-21A	21.0	25.0	19.0	5.6	
NB-22A	22.0	25.8	19.3	5.5	
NB-23A	23.0	26.4	20.4	5.5	250
NB-24A	24.0	27.0	20.8	5.3	
NB-27A	27.0	34.6	27.0	6.0	500
NB-29A	29.0	34.0	26.3	7.0	
★NB-30A	30.0	36.25	28.0	7.0	
NB-32A	32.0	36.9	30.0	6.7	

5

# SNAP BUSHING

PLASTECH

- MATERIAL: NYLON 66 (UL)
- FLAME CLASS :94V-2
- COLOR: BLACK
- UNIT: mm

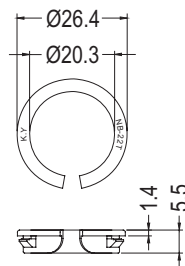

CHASSIS Ø22  
THICKNESS 0.6~0.8



PART NO	PACKAGE
NB-22T	500