

# HOLE PLUGS

**PLASTECH**

- MATERIAL:NYLON 66 (UL)
- FLAME CLASS:94V-2
- COLOR:BLACK
- UNIT:mm

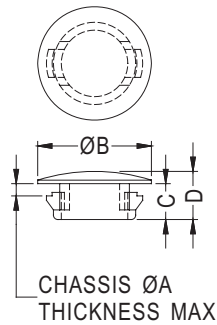

PART NO	A	B	C	D	THICKNESS	PACKAGE
M04	4.8	6.35	4.5	5.5	1.6	2000
M06	6.4	7.6	4.5	5.6	1.6	
M09S	9.5	13.0	4.1	5.5	1.4	1000
M13.5	13.5	15.2	5.0	6.2	2.2	
M16S	15.9	20.0	6.5	7.7	2.0	

# HOLE PLUGS

**PLASTECH**

- MATERIAL:NYLON 66 (UL)
- FLAME CLASS :94V-2
- COLOR:BLACK/WHITE
- UNIT:mm

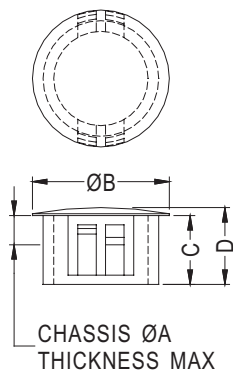

PART NO	A	B	C	D	THICKNESS	PACKAGE
M08	8.0	9.5	6.4	7.6	1.6	1000
M09A	9.0	11.5	8.6	10.1	3.3	
M09	9.5	11.9	8.6	10.1	3.3	
M11	11.0	14.0	9.0	10.1	3.3	500
M12	12.0	14.3	9.0	10.1	3.3	
M13	12.7	14.6	9.0	10.1	3.3	
M16	16.0	18.7	9.3	10.6	3.3	
M19	19.0	23.2	8.7	10.3	3.3	
M22	22.2	25.4	9.9	11.0	3.3	
M25	25.4	28.4	9.6	11.0	3.3	200
M28	28.0	32.0	12.0	13.1	3.3	
M30	30.0	34.2	10.0	11.3	3.3	

# HOLE PLUGS

**PLASTECH**

- MATERIAL:NYLON 66 (UL)
- FLAME CLASS :94V-2
- COLOR:BLACK/WHITE
- UNIT:mm

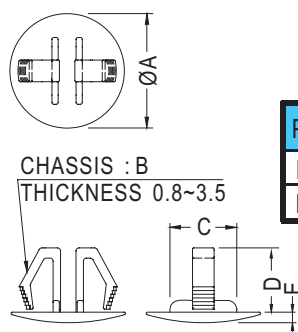

PART NO	A	B	C	D	E	PACKAGE
MBWK-1	18.5	Ø11~Ø14	9.8	10.4	1.7	500
MBWK-2	30.0	Ø22~Ø26	15.5	11.6	1.9	